

# USER'S MANUAL

Compatible with SONY

NAVIGATION UNIT

NAVIGATION UNIT

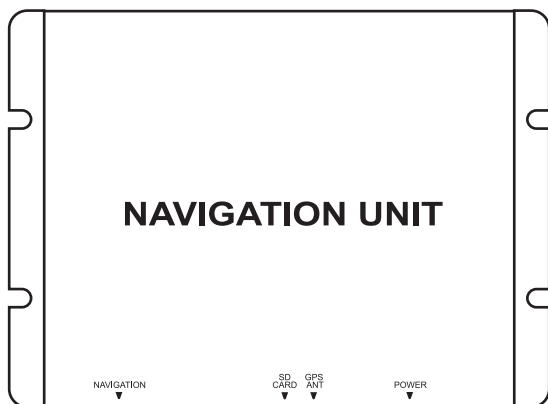

# 1. Before using the product

For safe and convenient driving, please read this user's manual before use.  
The company takes no responsibility for any financial, intellectual or emotional damages caused if the instructions in this manual are not followed.



## Safety precautions



**Location of installation:** The product may fall while driving. Please secure it safely during installation.



**Do not operate while driving:** The driver operating or paying attention to the product while driving may cause accidents. Please park or pull over to a safe spot before use.



**Do not use for prolonged period while the engine is turned off:** If the engine is turned off and the product is in use for prolonged periods of time, the battery of the vehicle may go flat. Please start the engine before use.



**Safe installation of product:** Please turn the engine off and the power off the product before installation.



## Precautions before use



**Not recommended for extreme temperatures:** The product and the remote control may not operate correctly in extremely high or low temperatures. The ideal storage temperature for the remote control batteries is between 5-25 degrees. In summer and winter, please be careful in operating and storing the product.



**Cleaning the product:** The product must not come in contact with any chemicals or cleaners containing benzene or paint thinners. Only clean externally with a dry cloth.



**Do not alter, fix or add impact to the product:** Any attempt to alter or fix the product by the user can result in malfunctioning. Excessive impact on the product may cause malfunction and/or damages.

## 2. Before using the product

<b>1. Before using the product</b> .....	<b>2</b>
Safety precautions .....	2
Precautions before use .....	2
<b>2. Contents</b> .....	<b>3</b>
<b>3. Introduction</b> .....	<b>4</b>
<b>4. Disclaimer</b> .....	<b>4</b>
<b>5. Checking components</b> .....	<b>5</b>
<b>6. Installing the product</b> .....	<b>7</b>
<b>7. Using the Navigation</b> .....	<b>9</b>
<b>8. SD Card</b> .....	<b>10</b>
<b>9. Frequently asked questions</b> .....	<b>11</b>
Symptoms and check points .....	11
<b>10. Product specifications</b> .....	<b>11</b>
<b>11. Product warranty</b> .....	<b>12</b>

### 3. Introduction

This product has navigation functions that can be used connected with certain head unit.

The navigation can be controlled directly from the touch screen on the AV device. There is no need for extra remote controls or other devices, and the interior of the car can be protected.

All issues of upgrading map software are in charge of map provider, depending on the policy of map software company.

### 4. Disclaimer

Neither the manufacturer, importer nor the retailer holds responsibility for any damages caused deliberately or by incorrect use or operation of the product, including injuries.

## 5. Checking components

The diagram below is only to assist in understanding of the description, and may look different from the actual product.

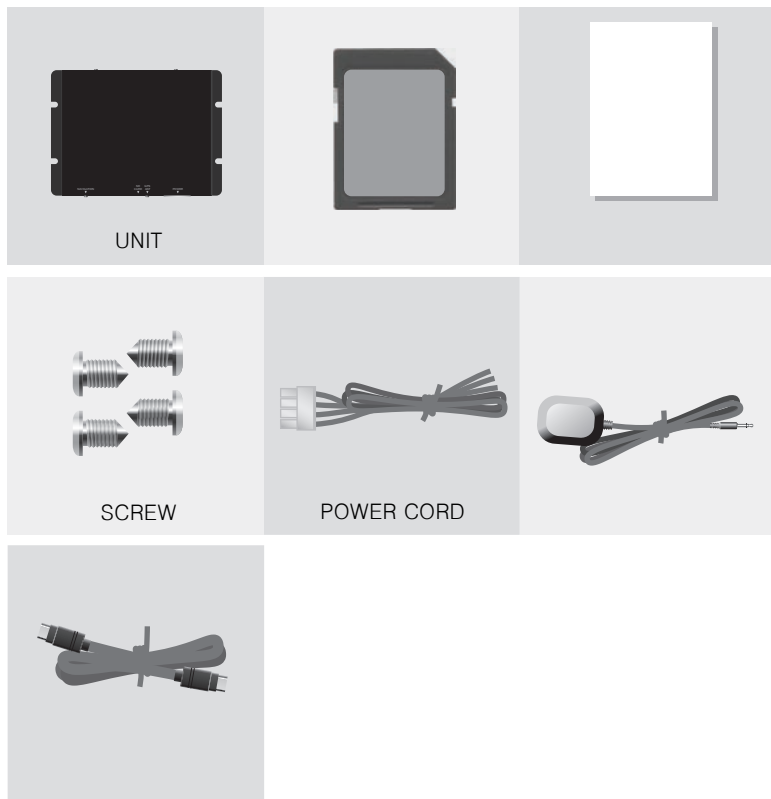

## 6. Installing the product

For more convenient and safer installation, please contact the nearest specialized installation agent. The product may be installed differently depending on the model of the vehicle and the individual desire of the customer.

Before connecting the antenna or the power supply, please turn off the engine. The product must be switched off during installation.

### **1** Installing the GPS antenna

1. Insert each antenna cable into the antenna socket.
2. It is recommended that the antennas be installed on the exterior of the vehicle.

### **2** Connecting the Navigation

1. Connect the navigation cable to the navigation terminals of the main unit and the AV device.
2. Insert the SD card into the main unit.

# 7. Using the navigation

## Navigation SETUP (for SONY AV)

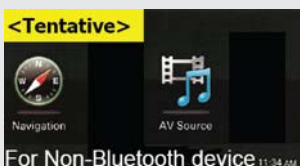

- 1 When Navigation is connected to AV device, TOP layer shown left will appear. Make sure whether this screen appears.

### NOTE:

When Navigation is not connected or connected incorrectly, Navigation icon doesn't appear.  
In case Navigation is connected before turning AV device on, reset AV device once following Instruction Manual of AV.

- 2 Turn the AV device on and touch "View Change" button.

- 3 **Select screen mode**

- Navigation ⇔ AV screen  
Switch alternately by pushing "TOP" button more than two seconds
- FULL Navigation  
FULL Navigation VIEW with direct operation for Navigation from the screen
- NAVI / AV Dual Screen (Big)  
AV window on Navigation screen
- NAVI / AV Dual Screen (Small)  
AV operation icon on Navigation

## Navigation SETUP (for SONY AV)

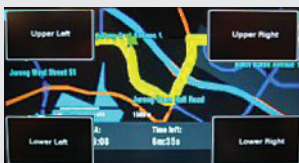

NAVI / AV Dual Screen (Big)

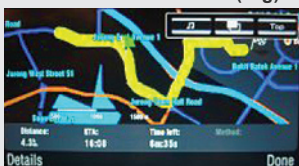

NAVI / AV Dual Screen (Small)

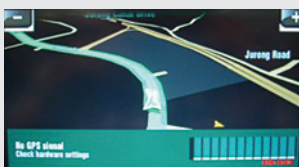

NAVIGATION FULL

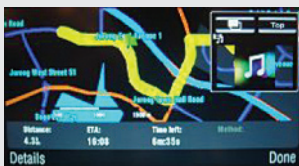

NAVI / AV Dual Screen (Big)

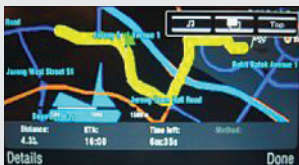

NAVI / AV Dual Screen (Small)

### 4 Select screen position

NOTE:  
only appears when select NAVI / AV  
dual screen

### 5 Navigation screen appears according to selection

Just touch the Screen and operate  
Navigation

### NAVI / AV Dual Screen

Touch the Navigation area once and  
then operate Navigation after AV icon  
disappears



## Connecting diagram (for SONY AV)

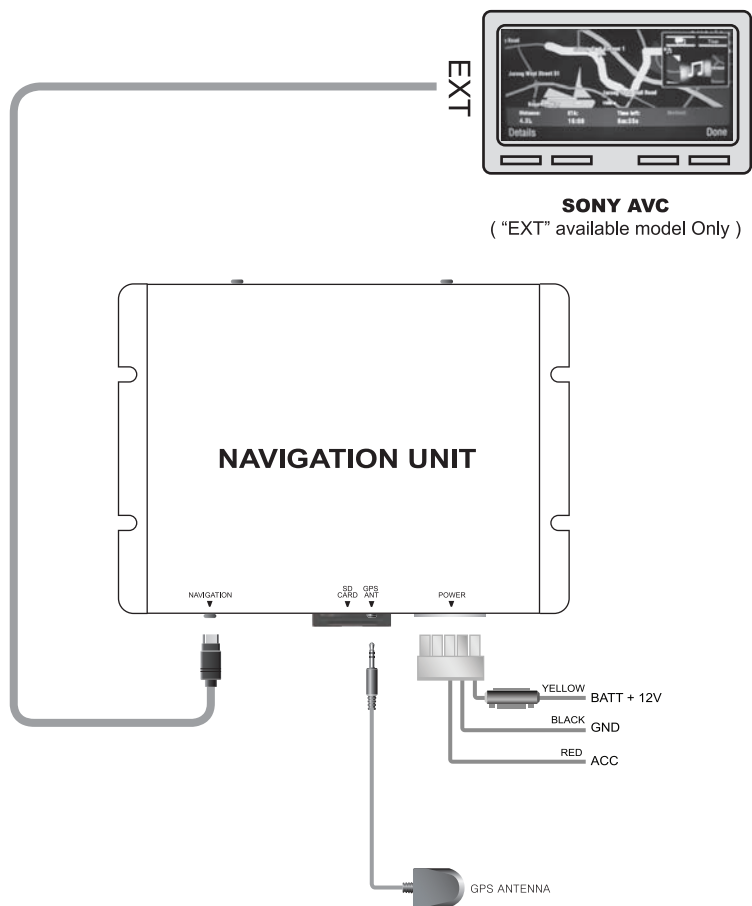

Please insert the SD card before the main unit is turned on, and do not take it out while it is in use.

## SD Memory connectivity Error

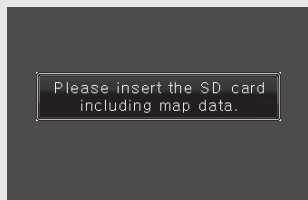

If SD memory card is not inserted correctly, warning message comes on [Please insert the SD card including the map data].

Some AV devices, touch screen function is not working, while removing the SD card.

## 8. SD Card



Before installation or after updating the Navigation, insert the SD Card into the slot shown above.

## 9. Frequently asked questions

If the product doesn't work properly, please check the points below.  
If problem persists, please contact your local service centre.

Symptom	Check points
I can't turn it on.	<ul style="list-style-type: none"><li>■ Fully insert the power connector.</li><li>■ Check the fuse on the power supply line (yellow) and replace it if needed. (250V/3A)</li></ul>
There is bad reception.	<ul style="list-style-type: none"><li>■ Make sure the antennas are inserted correctly.</li></ul>
The Navigation doesn't work.	<ul style="list-style-type: none"><li>■ Make sure the SD Card is inserted correctly.</li><li>■ Check the connection of the Navigation cables.</li></ul>

## 10. Product specifications

Operating Voltage	10.5V ~ 16V
Operating Temp	-20°C ~ +80°C
Audio Output Level	500 mV ±3dB
Video Output Level	0.7Vpp ± 0.1Vpp

## 11. Product warranty

# Product Warranty

- 1 This product was manufactured under strict quality control and inspection.
- 2 1-year free warranty is available in cases of malfunction, with exception of damage by consumer negligence.
- 3 After purchase, please fill out the form below and keep it with the receipt.
- 4 Please present the warranty when requesting after-sales service.
- 5 Please keep the warranty in a safe place as it is not reissuable.

Product information	
Model	
Serial number	
Retailer information	
Name	
Address	
Phone number	
Consumer information	
Name	
Address	
(Mobile) phone number	
Email address	
Date of purchase	
Service required	

# NAVIGATION UNIT